



Construction Fasteners



Jan 2014



Construction Fasteners

The Zipco range of quality construction fasteners are designed for strength and durability - to last longer. All the fasteners are available in 3 different coatings*: Zinc Plated; Ceramic & Class 3. The main function of these coatings is to control corrosion and withstand demanding Indian weather conditions. An exception being the Gypsum screws which comes in a black phosphate finish and are best suited for dry wall fixing. These screws are self drilling, which makes them easier to fix directly without having to drill a hole. Choice of diameters and lengths ensure proper selection for application.

Clip Fixing

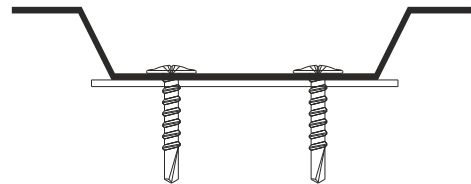

Made out of hardened C-1022 steel for better strength & durability. Used for fixing clip lock clamps on steel purlins. The Tips of the screw are so designed that it can perform a self drilling while screwing. Washer head covers more area.

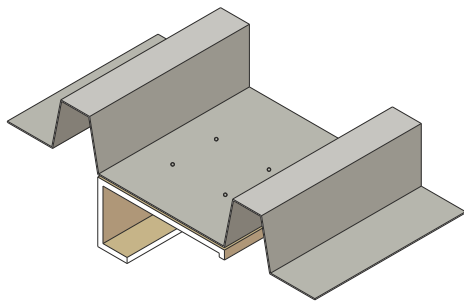

Code	Size	PT.	Coating*
ZFP525A	4.8-16 x 25	FT3.5	Zinc
ZFP525B	4.8-16 x 25	FT3.5	Ceramic
ZFP525C	4.8-16 x 25	FT3.5	Class 3

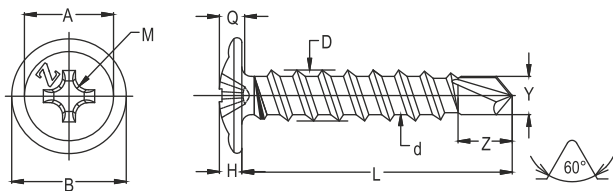

Specification	B		A	H		M	Q		D		d		P	Z		Y		Case Depth	Torque
Size	Min	Max	Ref.	Min	Max	NO	Min	Max	Min	Max	Min	Max	≡	Min	Max	Min	Max	mm	Kg-cm Min
M4.8	10.8	11.6	7.30	2.35	2.65	#2	1.80	2.45	4.63	4.82	3.25	3.45	1.59	5.00	6.00	3.86	4.03	0.10-0.23	71

* Refer to the box on Surface Finish Specifications and Testing Parameters in this folder.

Valley Fixing

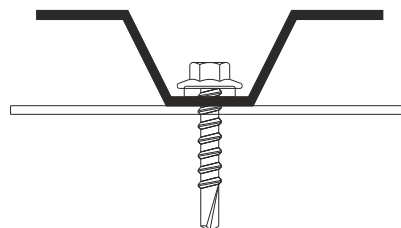

Made out of hardened C-1022 steel for better strength & durability. Used for fixing cladding & wall curtains / steel purlins up to 4.5mm thick. The Tips of the screw are so designed that it can perform a self drilling while screwing. Flanged head covers more area. EPDM washers provided.

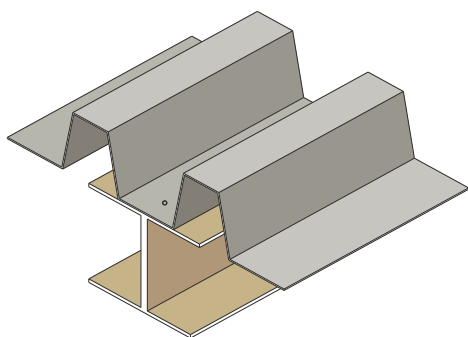

Code	Size	PT.	Coating*
ZFV1019A	10-16 x 19	FT3	Zinc
ZFV1019B	10-16 x 19	FT3	Ceramic
ZFV1019C	10-16 x 19	FT3	Class 3
ZFV1225A	12-14 x 25	FT3.5	Zinc
ZFV1225B	12-14 x 25	FT3.5	Ceramic
ZFV1225C	12-14 x 25	FT3.5	Class 3
ZFV1235A	12-14 x 35	FT3.5	Zinc
ZFV1235B	12-14 x 35	FT3.5	Ceramic
ZFV1235C	12-14 x 35	FT3.5	Class 3

Code	Size	PT.	Coating*
ZFV1245A	12-14 x 45	FT3.5	Zinc
ZFV1245B	12-14 x 45	FT3.5	Ceramic
ZFV1245C	12-14 x 45	FT3.5	Class 3
ZFV1255A	12-14 x 55	FT3.5	Zinc
ZFV1255B	12-14 x 55	FT3.5	Ceramic
ZFV1255C	12-14 x 55	FT3.5	Class 3
ZFV1270A	12-14 x 70	FT3.5	Zinc
ZFV1270B	12-14 x 70	FT3.5	Ceramic
ZFV1270C	12-14 x 70	FT3.5	Class 3
ZFV1290A	12-14 x 90	FT4	Zinc
ZFV1290B	12-14 x 90	FT4	Ceramic
ZFV1290C	12-14 x 90	FT4	Class 3
ZFV12100A	12-14 x 100	FT4	Zinc
ZFV12100B	12-14 x 100	FT4	Ceramic
ZFV12100C	12-14 x 100	FT4	Class 3

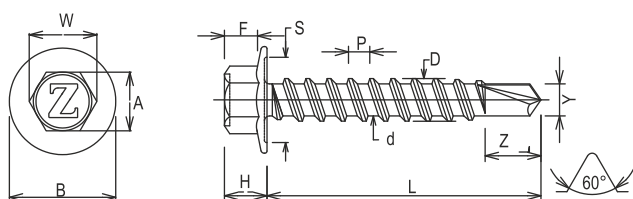

#3.0 TP

Specification		A	W	H	F	B	S	D	d	P	Z	Y
#10-16	Max	8.00	-	4.83	3.30	11.43	Ref.	4.80	3.58	-	6.50	4.18
	Min	7.78	8.64	4.32	2.80	10.67	9.30	4.65	3.43	1.59	5.90	4.08

#3.5 TP #4.0 TP

Specification		A	W	H	F	B	S	D	d	P	Z	Z	Y
#12-14	Max	8.00	-	6.00	3.94	14.78	11.80	5.46	4.17	-	9.00	-	4.75
	Min	7.78	8.64	5.18	3.61	13.97	11.60	5.31	3.99	1.81	8.00	12.00	4.65
Nominal Length	L	20	25	30	35	45	50	55	65	68	70	70	75
	Max	20.00	25.00	30.00	35.00	45.00	50.00	55.00	65.00	68.00	70.00	70.00	75.00
	Min	19.20	24.20	29.20	34.20	44.20	49.20	54.20	64.20	67.20	69.20	69.20	74.20

* Refer to the box on Surface Finish Specifications and Testing Parameters in this folder.

Crest Fixing

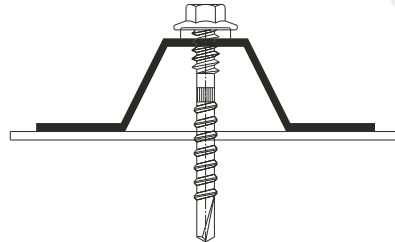
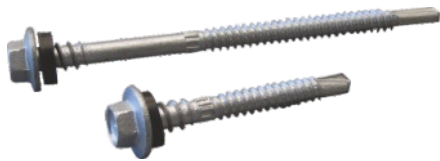

Made out of hardened C-1022 steel for better strength & durability. Used for crest fixing of roofing sheets/ steel purlins up to 4.5mm thick. The Tips of the screw are so designed that it can perform a self drilling while screwing. Flanged head covers more area. EPDM washers provided.

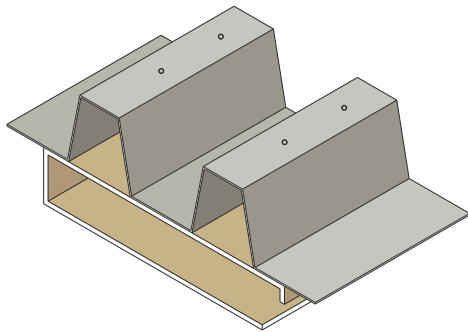

Code	Size	PT.	Coating*
ZFC1255A	12-14 x 55	DT3.5	Zinc
ZFC1255B	12-14 x 55	DT3.5	Ceramic
ZFC1255C	12-14 x 55	DT3.5	Class 3
ZFC1270A	12-14 x 70	DT3.5	Zinc
ZFC1270B	12-14 x 70	DT3.5	Ceramic
ZFC1270C	12-14 x 70	DT3.5	Class 3
ZFC1290A	12-14 x 90	DT4	Zinc
ZFC1290B	12-14 x 90	DT4	Ceramic
ZFC1290C	12-14 x 90	DT4	Class 3
ZFC12100A	12-14 x 100	DT4	Zinc
ZFC12100B	12-14 x 100	DT4	Ceramic
ZFC12100C	12-14 x 100	DT4	Class 3
ZFC12120A	12-14 x 120	DT4	Zinc
ZFC12120B	12-14 x 120	DT4	Ceramic
ZFC12120C	12-14 x 120	DT4	Class 3

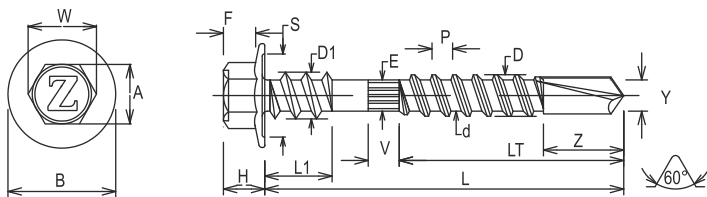

Specification		A	W	H	F	B	S	E	V	D1	L1	D	d	P	Z	Y
#12-14	Max	8.00	-	6.00	3.94	14.78	11.80	Ref.	Ref.	6.45	10.30	5.46	4.17	-	9.00	4.75
	Min	7.78	8.64	5.18	3.61	13.97	11.60	4.80	3.00	6.30	10.00	5.31	3.99	1.81	8.00	4.65
Nominal Length	L	45	50	55	65	68	70	75	90	100	110	120	130	160		
	Max	46.00	51.00	56.00	66.00	69.00	71.00	76.00	91.00	101.00	111.00	121.50	131.50	161.50		
	Min	44.00	49.00	54.00	64.00	67.00	69.00	74.00	89.00	99.00	109.00	118.50	128.50	158.50		
Thread Length LT	Max	24.00	34.00	34.00	42.00	42.00	42.00	42.00	54.00	64.00	64.00	64.00	64.00	84.00		
	Min	23.00	33.00	33.00	40.00	40.00	40.00	40.00	52.00	62.00	62.00	62.00	62.00	82.00		

* Refer to the box on Surface Finish Specifications and Testing Parameters in this folder.

Surface Finish Specifications and Testing Parameters:

1) Class 3 Mechanical Galvanized per AS3566 can achieve the following 4 tests:-

- (a) 1000 hrs. of Neutral Salt Spray in accordance with AS 2331.3.1
- (b) 1000 hrs. of Relative Humidity in accordance with ASTM D2247
- (c) 2000 hrs. of UV Condensation in accordance with ASTM G154
- (d) 15 Cycles of Sulfur Dioxide (At level SFW 2.05) condensing atmosphere in accordance with DIN 50018

2) Silver Ceramic Coating can achieve the following tests:-

- (a) 1000 hrs. of Neutral Salt Spray in accordance with AS 2331.3.1
- (b) 15 Cycles of Sulfur Dioxide (At level SFW 2.05) condensing atmosphere in accordance with DIN 50018

3) Hexavalent Zinc Plating can achieve the following test:-

- (a) 24 hrs. Salt Spray Test only.

Dry Wall (Gypsum) Screws



Made out of C-1018 / C-1022 steel, case hardened with fine threads for gypsum boards. Available in black phosphate finish. Available in 3 sizes: 3.5x25mm, 3.5x35mm & 3.5x45mm.

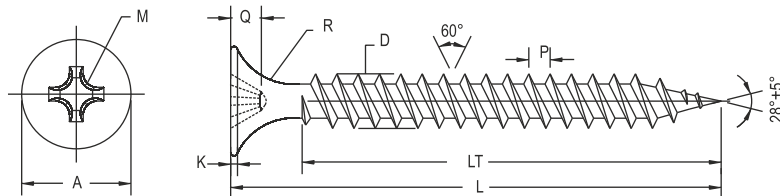

Code	Size	Finish
ZDWS 3519	3.5 X 19mm	Black
ZDWS 3525	3.5 X 25mm	
ZDWS 3535	3.5 X 35mm	
ZDWS 3545	3.5 X 45mm	
ZDWS 3550	3.5 X 50mm	

Specification Size	A		M	Q		K		P	D		R		Torsion	Thread Length	
	Min	Max	NO	Min	Max	0.50	0.80		Min	Max	Min	Max	Kg-cm Min	L	LT+/-1.0
#6 (M3.5)	8.00	8.40	#2	2.38	2.93	0.50	0.80	1.50	3.40	3.65	4.00	5.00	27.7	up to 2" incl.	Full
#7 (M3.9)	8.00	8.40	#2	2.38	2.93	0.50	0.80	1.59	3.75	4.00	4.00	5.00	35	Over 2" to 3"	50mm
#8 (M4.2)	8.00	8.40	#2	2.38	2.93	0.50	0.80	1.69	4.05	4.30	4.00	5.00	45	Over 3"	60mm
#10 (M4.8)	8.50	9.00	#2	2.65	3.10	0.50	0.80	2.12	4.70	4.95	4.00	5.00	65		



Kitchen Baskets & Accessories (SS 202)

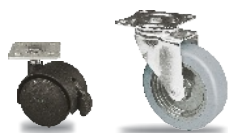

Castors



SS Friction Hinges



Ball Bearing Slides



SS Door Hinges with Ball Bearing



Concealed Hinges



10mm Handles SS202

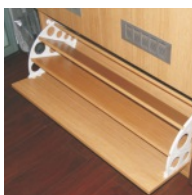

Shoe Rack Fittings



EFFIPRESS ENGINEERING PVT. LTD.

Plot No. 47, Phase I, Genesis Industrial Complex, Kolgaon, Palghar, Dis. Thane 401404.

Tel.: 02525-645175 / 605267. Fax: 02525-256181.

Email: info@zipco.in Website: www.zipco.in